

LAYOUT OF MACHINES AND FACILITIES

Andrew Kusiak, Professor
 Industrial Engineering
 2139 Seamans Center
 The University of Iowa
 Iowa City, Iowa 52242 - 1527

Tel: 319 - 335 5934 Fax: 319-335 5669
andrew-kusiak@uiowa.edu
<http://www.icaen.uiowa.edu/~ankusiak>

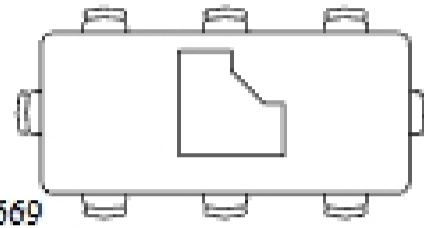

The University of Iowa

Intelligent Systems Laboratory

Outline

- LAYOUT EXAMPLES
- SINGLE-ROW MACHINE LAYOUT
- DOUBLE-ROW MACHINE LAYOUT
- MULTIROW FACILITY LAYOUT
- ALGORITHMS



Latest layout software *Proplanner*

<http://www.proplanner.com/product/details/flowpath.aspx>



The University of Iowa

Intelligent Systems Laboratory

Big Picture

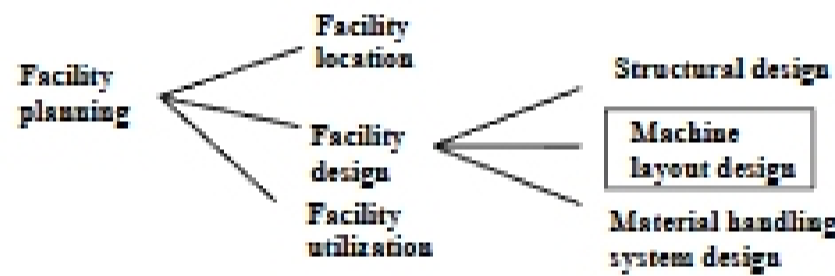

Jobs: Facility Designer
 Facility Planner

AutoCAD Software
<http://www.autodesk.com/>



The University of Iowa

Intelligent Systems Laboratory

LAYOUT EXAMPLES



The University of Iowa

Intelligent Systems Laboratory

MANUFACTURING FACILITY LAYOUT

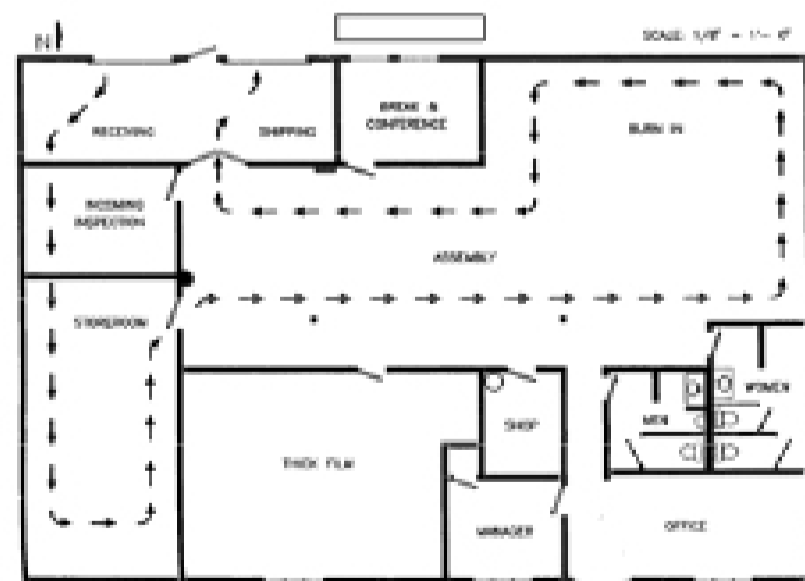

The University of Iowa

Intelligent Systems Laboratory

ASSEMBLY AREA LAYOUT

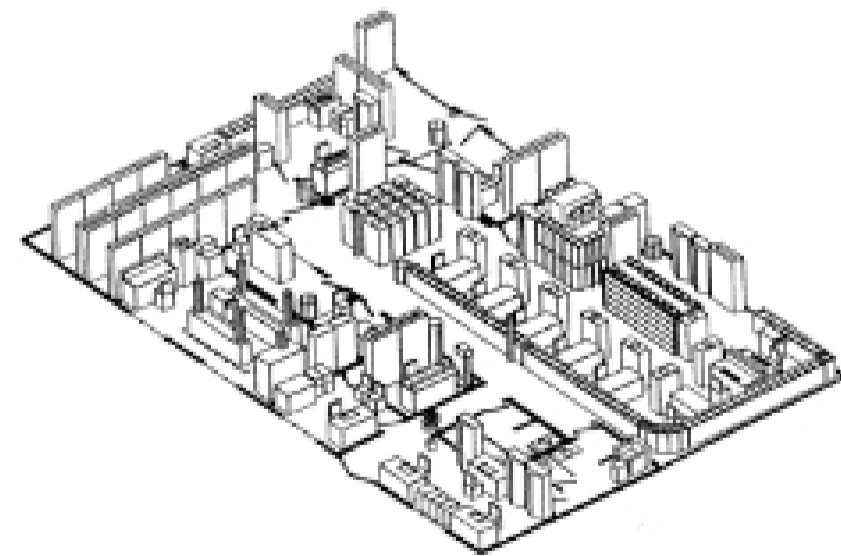

The University of Iowa

Intelligent Systems Laboratory

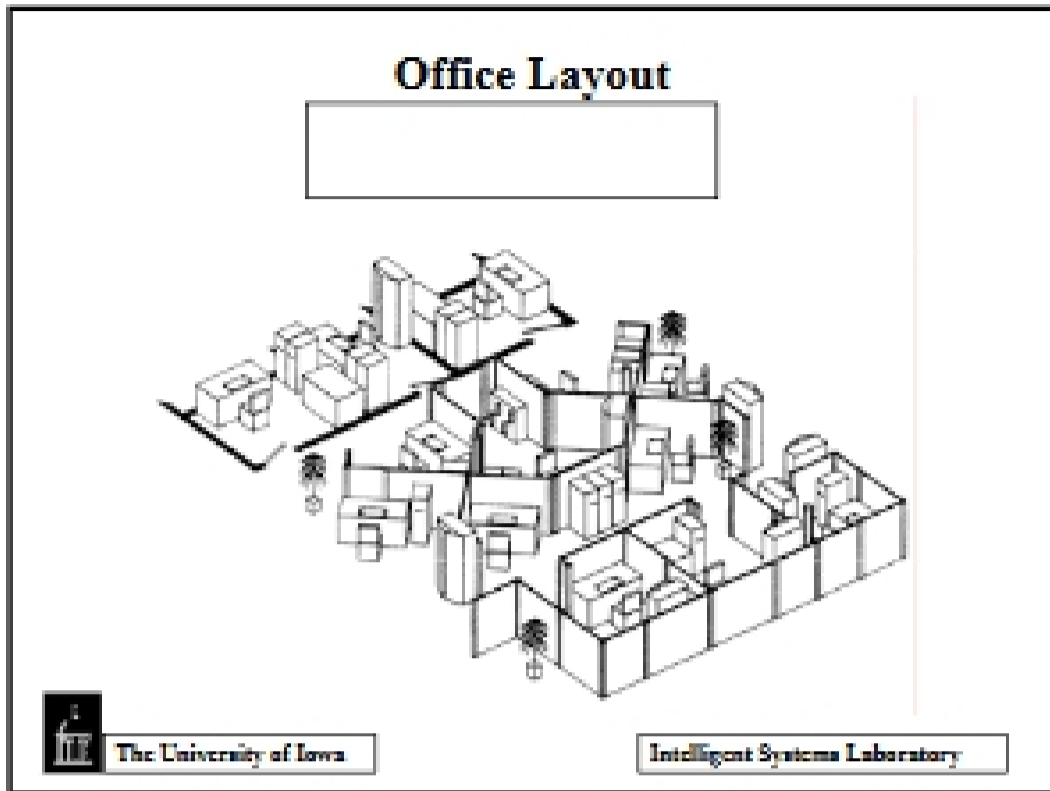

LAYOUT OF MACHINES

Methods:

- Visual, e.g., using templates
- Computer based (often an environment for evaluating various layout alternatives)
- Model based

 The University of Iowa

 Intelligent Systems Laboratory

LAYOUT OF MACHINES

Visualization types:

- 2D
- 3D
- Virtual reality

 The University of Iowa

 Intelligent Systems Laboratory

LAYOUT OF MACHINES Model Based Approach

Basic Layout Patterns

Single-Row Machine Layout

 The University of Iowa

 Intelligent Systems Laboratory

Double-Row Machine Layout

 The University of Iowa

 Intelligent Systems Laboratory

Multi-row Layout

 The University of Iowa

 Intelligent Systems Laboratory

BASIC DATA

- UNIT DISTANCE TRAVEL COST (c)
- OR FREQUENCY OF TRIPS (f)
- DISTANCE (d)
- OR TRAVEL TIME (t)



Intelligent Systems Laboratory

OBJECTIVE

Arrange machines on the shop floor in such a way that the total product of the travel cost per unit distance traveled [\$/m] and the distance traveled [m] is minimum.

Travel cost is often replaced with the number (frequency - f) of trips per time unit [1/sec] between any two machines.

Distance is replaced with travel time - t [sec].

$$\text{Min} \sum_{i=1}^n \sum_{j=1}^n \sum_{k=1}^n f_{ijk} t_{ij} x_{ij} x_{kl}$$



Intelligent Systems Laboratory

Example: Intuitive Machine Layout

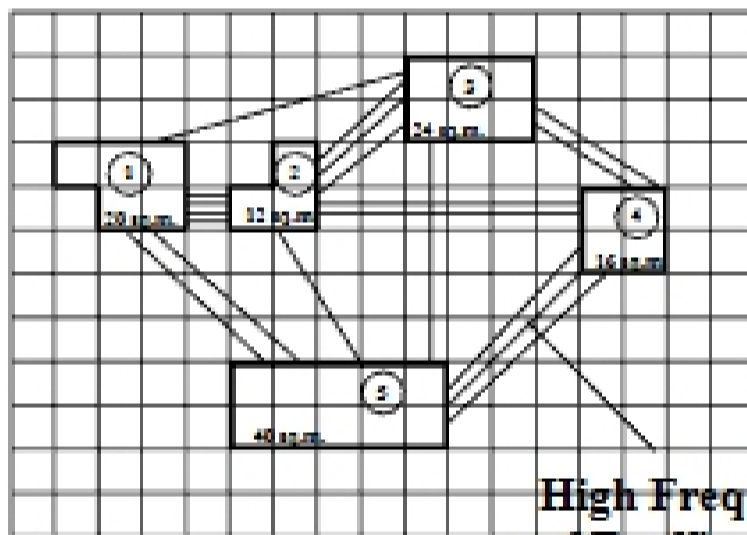

Intelligent Systems Laboratory

SINGLE-ROW MACHINE LAYOUT

Frequency of trips (traffic flow)

$$f_{ij} = \sum_{k=1}^n \left[\frac{v_{ij}^k}{u_k} \right]$$

- where:
- v_{ij}^k = volume of part type k to be moved from machine i to machine j in a given time horizon (for example, 1 year)
 - n_{ij} = number of different parts to be moved from machine i to machine j in a given time horizon
 - u_k = number of parts to be moved in a single trip of the material handling equipment
 - $[\cdot]$ = smallest integer greater than or equal to \cdot



Intelligent Systems Laboratory

The AGV travel time involves:

- loading time
- acceleration time
- travel time
- deceleration time
- unloading time



Intelligent Systems Laboratory

DISTANCE CALCULATION

Consider 3 machines

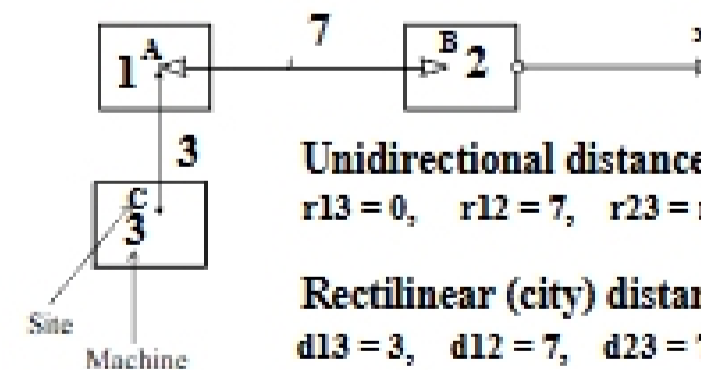

Unidirectional distance (along x axis)
 $r_{13} = 0, r_{12} = 7, r_{23} = r_{12} = 7$

Rectilinear (city) distance
 $d_{13} = 3, d_{12} = 7, d_{23} = 7 + 3 = 10$

Euclidean distance
 $e_{12} = 7, e_{13} = 7.48$



Intelligent Systems Laboratory